

SCOPE OF WORK:

- 1- ELEVATE EXISTING WATER CONCRETE (2' X 4') BY TWO (2) FEET HIGH WITH TWO (2) LAYER OF #3 RSB @ 6" O.C. BOTH WAYS SCOPE OF WORK.
- 2- ADJUST PLUMBING PIPE AND FITTINGS AS NEEDED, PROVIDE NEW PIPE, FITTINGS, GATE VALVES
- 3- CHANGE THE STEEL MANHOLE COVER WITH NEW 1/4 X 2X2 GALVANIZED FRAME AND GALVANIZED STEEL GRATING COVER.
- 4- INSTALL EXISTING STEEL DOOR, STRAIGHTING UP / FIXED DOOR AND CLEAN BEFORE INSTALLATION INSTALL NEW GALVANIZED HINGES FOUR (4) ON EACH DOOR.
- 5- ALL WORKS SHOULD BE PROPERLY COORDINATED WITH W. O. MANAGER OR HIS DESIGNEE.
- 6- CONTRACTORS RESPONSIBILITY TO MOBILIZE AND DEMOBILIZE ALL MATERIALS, MANPOWER, TOOLS AND OTHER MATERIALS NEEDED TO FINISH THIS PROJECT IN ACCORDANCE TO PPUC REQUIREMENTS AND SPECIFICATIONS.
- 7- CONTRACTORS RESPONSIBILITY FOR THE SAFETY OF ITS OWN WORKERS.

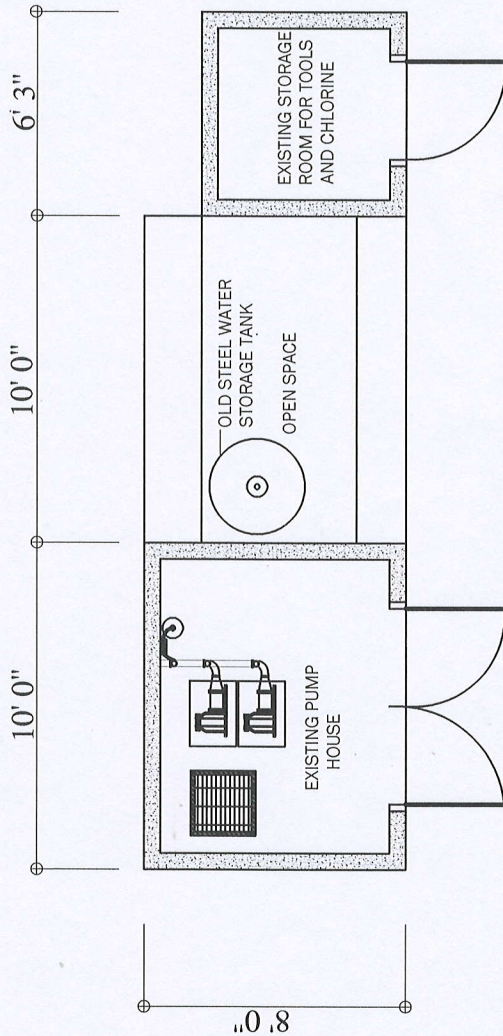

⊙ EXISTING FLOOR PLAN

PALAU PUBLIC UTILITIES CORP. P.O. BOX 1372 KOROR, REPUBLIC OF PALAU TEL. # 488-3872 FAX # 488-2880	PROJECT TITLE	OWNER:	DRAWN BY: SBM	SHEET CONTENT :	SHEET NO.:
	KAYANGELPUMP / CHLORINATOR BLDG. LOCATION:	PALAU PUBLIC UTILITIES CORP.	DESIGN BY: CHECKED BY:	EXISTING FLOOR PLAN	⊙

Detailed Estimate Sheet

Project: **KAYANGEL WATER FACILITY**
VARIOUS IMPROVEMENT
EXISTING WATER TANK FLOORING REPAIR

Item	DESCRIPTION	QTY.	UNIT
1	Equipment / MOBILIZATION		
	Manpower	12	DAYS
	MATERIALS BY BOAT	1	TRIP
	MATERIALS BY LAND	2	TRIP
	WELDING MACHINE	1	SET
2	Labor (12) days		
	1 - Foreman	12	c.days
	2 -WELDER / PAINTER	24	c.days
	4- SKILLED	48	c.days
3	MATERIALS		
	1/4 X 2 X 2 GALV. STEEL TUBE	60	PCS.
	1/4 X 2 X 2 GALV. ANGLE BAR	10	PCS.
	1/4 X 2 X 2 GALV. FLAT BAR	10	PCS.
	WELDING ROD	6	BOX
	POWER TOOLS	2	UNIT
	STEEL BRUSH	15	PCS.
	BLACK TAR	8	GAL.
	CONTINGENCY	1	L.S.
	RUSH CONVERTER	5	GAL.
	RED OXIDE PRIMER PAINT	12	GAL.
	FINISHING PAINT	12	GAL.
	SANDERS	12	EA.
	CONTINGENCY	1	L.S.
3	SAFETY EQUIPMENT		
	SAFETY BELT	4	SET
	PULLY WITH ROPE	1	SET
	SAFETY TOOLS	1	L.S.